

STONE BALLAST  
- SEE NOTE 6

STYROFOAM INSULATION  
- THICKNESS AS SPECIFIED

HYDROTECH ROOFING MEMBRANE  
ASSEMBLY - SEE NOTE 5

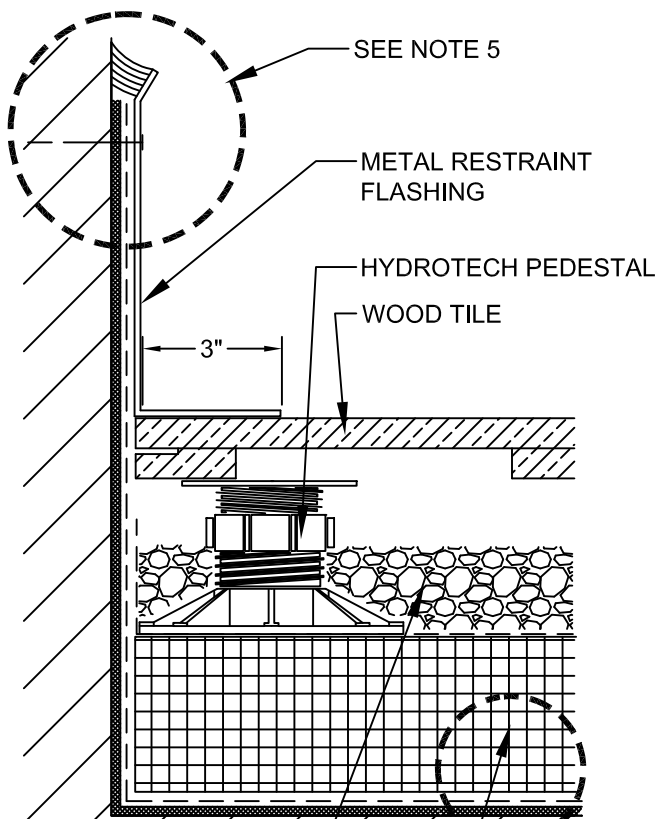

STONE BALLAST  
- SEE NOTE 6

STYROFOAM INSULATION  
- THICKNESS AS SPECIFIED

HYDROTECH ROOFING MEMBRANE  
ASSEMBLY - SEE NOTE 5

**NOTES:**

1. WOOD PAVERS ARE AVAILABLE IN A VARIETY OF WOOD SPECIES, SLAT COUNTS AND SIZES. CONTACT HYDROTECH FOR MORE INFORMATION.
2. METAL RESTRAINT FLASHING TO BE MADE FROM MINIMUM 0.080 GAUGE ALUMINUM OR STAINLESS AND SECURED 12" O.C.
3. METAL RESTRAINT FLASHING TO BE INSTALLED AT ALL TERMINATION POINTS (i.e., WALLS, PARAPETS, CURBS, ETC.)
4. WOOD TILE FASTENING KITS ARE NOT USED AT TERMINATION POINTS AS THE HYDROTECH PEDESTAL MUST BE PLACED INBOARD FROM THE PAVER CORNERS.
5. REFERENCE HYDROTECH MM6125 GUIDELINE DETAILS FOR MEMBRANE AND FLASHING DETAIL SPECIFICS AND ALTERNATIVES.
6. TYPICAL STONE BALLAST IS REQUIRED OVER THE INSULATION, INSTALLED AROUND THE PEDESTALS, IF A WIND RESISTANCE WARRANTY FOR THE STYROFOAM IS REQUIRED.



**ULTIMATE  
ASSEMBLY**

**AMERICAN HYDROTECH, INC.**

**WOOD PAVER  
OVER STYROFOAM INSULATION  
AND BALLASTED**

SCALE: NONE DATE: 11/06/20	UA-8B
-------------------------------	-------

This information is intended only for general conceptual purposes. It is based on data and knowledge considered to be true and correct. It is offered for the user's consideration, investigation and verification and is not intended to substitute for the advice provided by appropriate professionals. Hydrotech assumes no liability for the use of this information. The determination of the suitability and applicability of this information is the sole responsibility of the user.