

**DISK ANCHOR SECUREMENT**

**PERIMETER SECUREMENT**

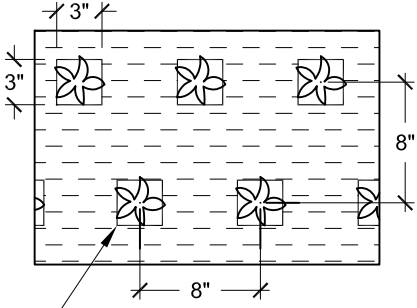

**PLANT INSTALLATION**

3" HOLES OR SQUARES TO BE CUT OUT OF GARDMAT. SLITS OR CROSS CUTS ARE NOT ACCEPTABLE

ALLOW SUFFICIENT ROOM FOR PLANTS TO GROW AND THRIVE

ONE OR MORE ROWS OF GARDMAT MAY BE REQUIRED AT PERIMETER - CONSULT HYDROTECH FOR PROJECT SPECIFIC REQUIREMENTS

ROLL FARTHEST FROM THE ROOF PERIMETER SHALL BE TUCKED UNDERNEATH ADJACENT ROLL WITH MIN. 4" OVERLAP

VEGETATION FREE ZONE; WIDTH VARIES

EROSION CONTROL ZONE; WIDTH VARIES

PARAPET WALL

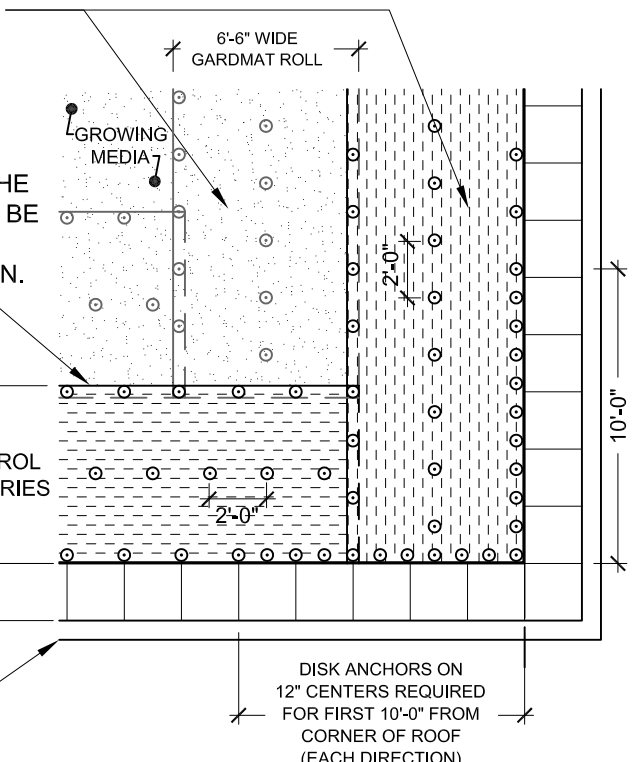

**LAYOUT AND ANCHORING**

**NOTE:**

1. ALL PROJECTS MUST BE REVIEWED PRIOR TO BID BY HYDROTECH'S TECHNICAL AND GARDEN ROOF DEPARTMENTS FOR SPECIFIC WIND UPLIFT REQUIREMENTS AND EROSION CONTROL SOLUTIONS

**HYDROTECH**

**GARDEN ROOF ASSEMBLY**

**AMERICAN HYDROTECH, INC.**

**DISK ANCHOR GUIDELINES FOR GARDMAT EROSION BLANKET**

SCALE: NONE  
DATE: 11/01/17

GA-8A

This information is intended only for general conceptual purposes. It is based on data and knowledge considered to be true and correct. It is offered for the user's consideration, investigation and verification and is not intended to substitute for the advice provided by appropriate professionals. Hydrotech assumes no liability for the use of this information. The determination of the suitability and applicability of this information is the sole responsibility of the user.