

METAL TERMINATION BAR
FASTENED 12" O.C. REF.
DETAIL W-9 AND 11 FOR
ALTERNATE TERMINATIONS

FLEX-FLASH UN

FOAM ROD OR TUBE

HYDROFLEX 30 OR OTHER
APPROVED PROTECTION

MONOLITHIC MEMBRANE
6125-FR

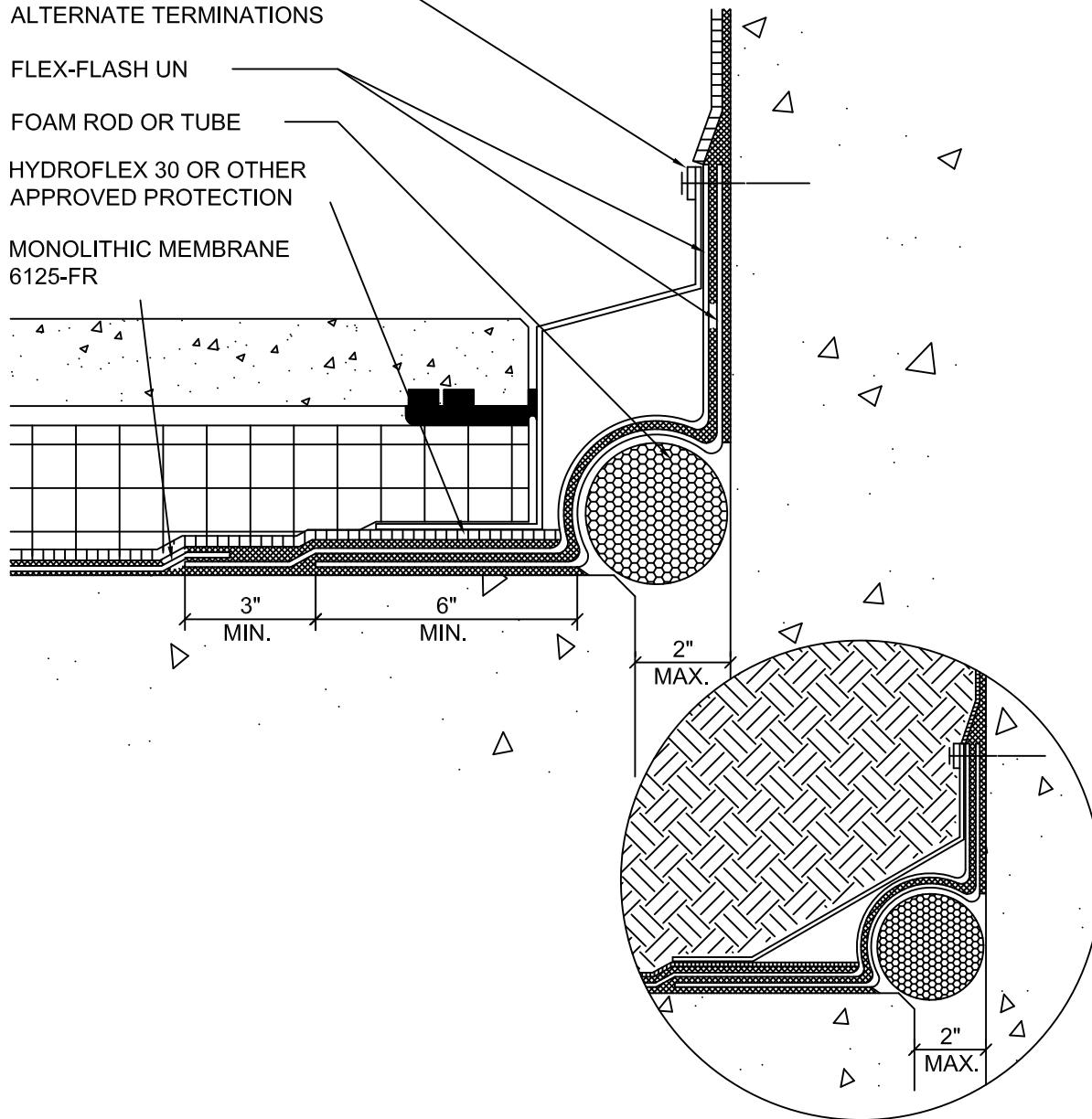

NOTES:

1. DETAIL DESIGNED FOR JOINTS WITH MAX. MOVEMENT ACCOMMODATION FACTOR OF 25%.
2. BACKER ROD SHOULD BE A MINIMUM 1" LARGER IN DIAMETER THAN MAXIMUM AS-BUILT JOINT OPENING.
3. IN COVERED/BURIED CONDITIONS, ADEQUATE PROTECTION MUST BE PROVIDED FOR FLASHING FROM SUBSEQUENT TOPPING/BACKFILL. WHENEVER POSSIBLE THE EXPANSION JOINT SHOULD BE EXTENDED UP THROUGH ALL TOPPING LAYERS.



**Monolithic
Membrane
6125-FR**
WATERPROOFING SYSTEMS

AMERICAN HYDROTECH, INC.

**DECK-TO-WALL EXPANSION JOINT
1"-2" MAX. AS BUILT WIDTHS**

**SCALE: NONE
DATE: 11/01/17**

W-6C