

**(A)** WITHOUT TOPPING SLAB

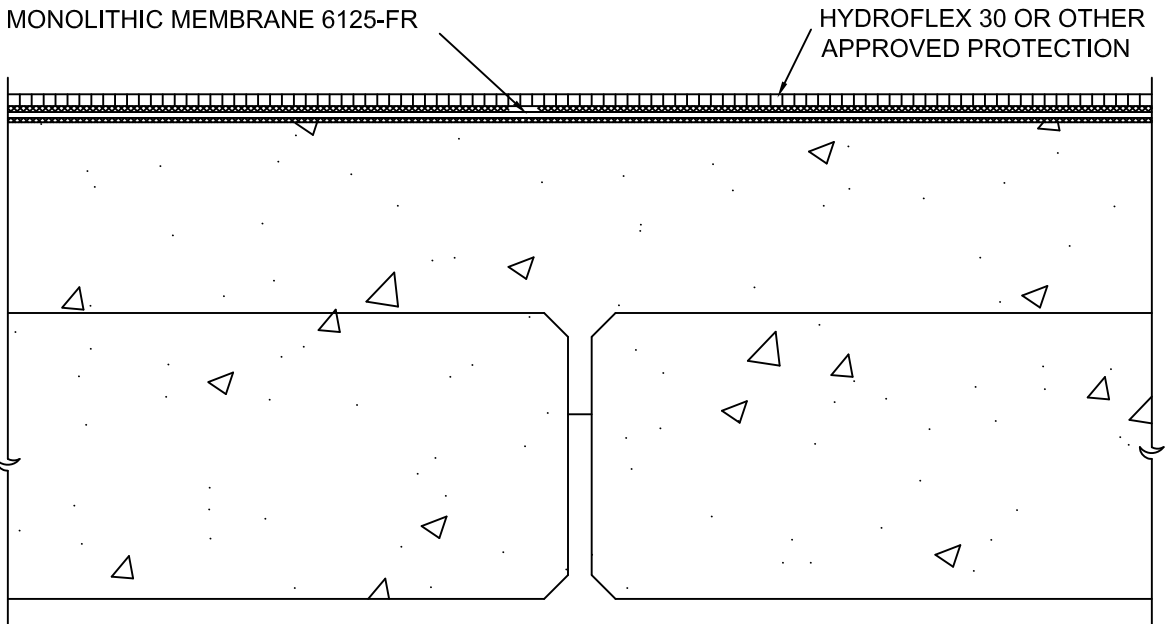

**(B)** WITH TOPPING SLAB

**NOTES:**

1. JOINTS MUST BE GROUDED OR CAULKED FLUSH
2. JOINT REINFORCING REQUIRED PRIOR TO APPLICATION OF STANDARD OR FABRIC REINFORCED MEMBRANE ASSEMBLY

**Monolithic Membrane 6125-FR**  
WATERPROOFING SYSTEMS

**AMERICAN HYDROTECH, INC.**

<b>PRECAST CONCRETE PLANK/PANEL JOINT TREATMENT</b>	
SCALE: NONE DATE: 11/01/17	W-5A

This information is intended only for general conceptual purposes. It is based on data and knowledge considered to be true and correct. It is offered for the user's consideration, investigation and verification and is not intended to substitute for the advice provided by appropriate professionals. Hydrotech assumes no liability for the use of this information. The determination of the suitability and applicability of this information is the sole responsibility of the user.